

Plastic air supply and exhaust valve

KPP



Description

KPP air valves are designed for air supply and exhaust systems. They are made from white PVC and as a result, they are corrosion-resistant. The air flow rate is adjusted by twisting the disk closure in and out of the bezel. The opening ratio is fixed with a locknut. The carefully designed geometry of the valve guarantees low noise levels. The KPP air valve is fastened to the ductwork end via a mounting frame, which is delivered with the valve. The KPP valve only needs to be press-fitted in the mounting frame.

Product code example

Product code: **KPP - aaa**

type _____
 $\varnothing d_1$ _____

Dimensions

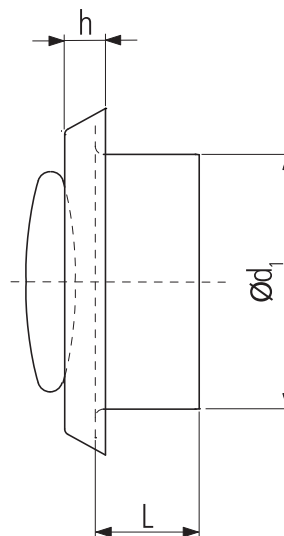

Product code	$\varnothing d_1$ (mm)	L (mm)	h (mm)
KPP-100	100	50	15
KPP-125	125	50	15
KPP-150	150	50	15
KPP-160	160	50	15
KPP-200	200	50	15