

KVK Slim 125 EC

Centrifugal circular duct fan <125W

Item Number: 92150

Variant: 230V 1~ 50/60Hz



- Slim design, easy to install
- Easy maintenance, service cover
- Low sound level, insulated cover
- High efficiency and low SFP in a real working point
- Potentiometer included, possible to speed control 0-100%
- Simple to install, mounting brackets included
- Integrated motor protection
- Aluzinc casing, C4 corrosion class

KVK Slim is a box fan with circular duct connections. The lid is insulated to keep a low sound level. The fan can be installed in any position. The casing is manufactured from Aluzinc in corrosion class C4. A service cover with screw connection makes it easy to open for service and cleaning.



KVK Slim EC is delivered with integrated motor protection and pre-wired potentiometer (0-10V) that allows you to easily find the desired working point. The fan can be demand controlled via sensors for CO₂, temperature, humidity, presence indication and VAV.

Size 315-500 also offers possibility to communication via Modbus.

The FK mounting clamp (accessory) facilitates easy installation and removal and prevents the transfer of vibration to the duct.

Technical parameters

Nominal data		
Voltage (nominal)	230	V
Frequency	60; 50	Hz
Phase(s)	1~	
Input power	118	W
Input current	0.9	A
Impeller speed	2,605	rpm
Air flow	max 0.137	m ³ /s
Temperature of transported air	max 60	°C
Max temperature of transported air, when speed controlled	60	°C
Sound data		
Sound pressure level at 3m (20m ² Sabin)	47	dB(A)
Protection/Classification		
Enclosure class, motor	IP54	
Insulation class	B	

Data according to ErP

Energy class, Basic unit	E
Energy class, Local demand	B
ErP ready	ErP 2018

Dimensions and weights

Duct dimension; Circular, inlet	125 mm
Duct dimension; Circular, outlet	125 mm
Weight	5.6 kg

Others

Duct connection type	Circular
Motor type	EC

Performance

Performance curve

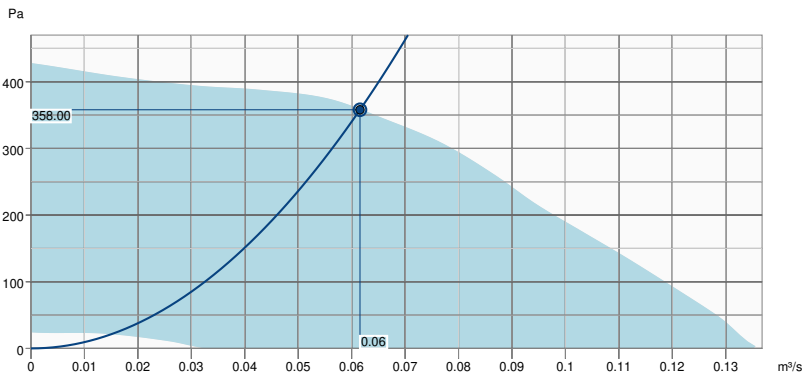

Hydraulic data	
Required air flow	0.06 m³/s
Required static pressure	358 Pa
Working air flow	0.06 m³/s
Working static pressure	358 Pa
Air density	1.204 kg/m³
Power	89.4 W
Fan control - RPM	2950 rpm
Current	0.70 A
SFP	1.452 kW/m³/s
Control voltage	10.0 V
Supply voltage	230 V

Sound power level		63	125	250	500	1k	2k	4k	8k	Total
Inlet	dB(A)	59	67	66	65	62	60	58	51	72
Outlet	dB(A)	58	68	71	70	68	68	63	57	76
Surrounding	dB(A)	29	40	48	47	48	47	41	32	54
Sound pressure level at 3m (20m² Sabine)	dB(A)	-	-	-	-	-	-	-	-	47
Sound pressure level at 3m free field	dB(A)	-	-	-	-	-	-	-	-	33

Dimension

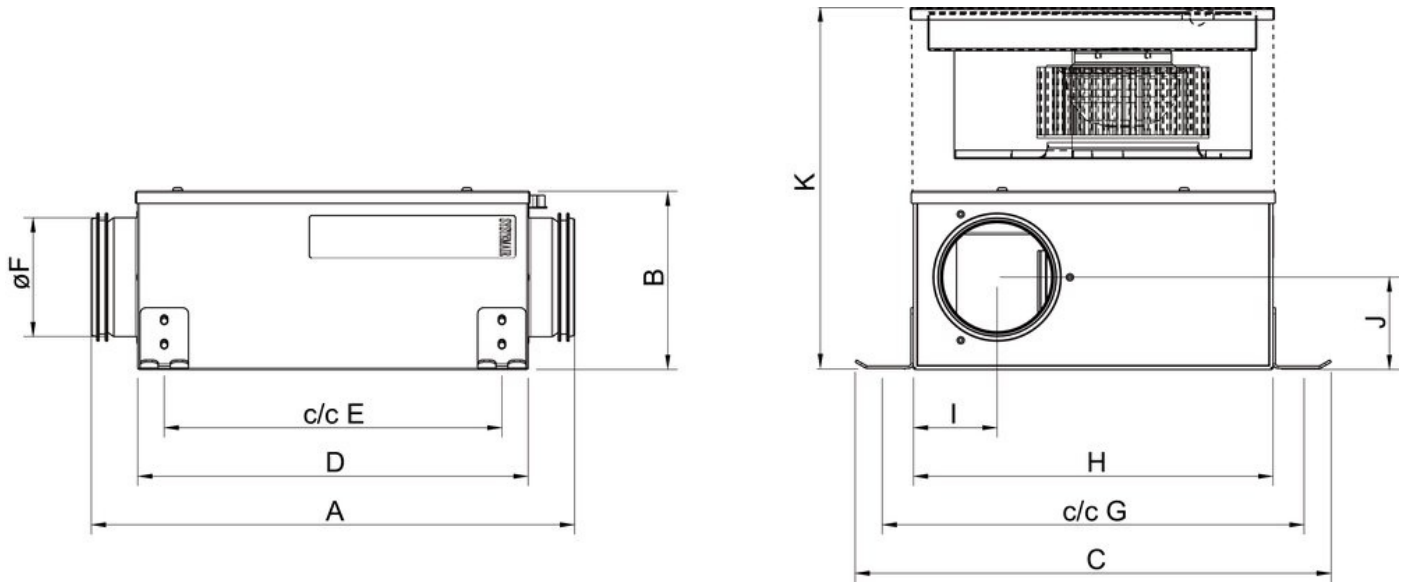

	A	B	C	D	E	øF	G	H	I	J	K
KVK Slim 100	400	150	392	325	278	98	348	300	69	76	300
KVK Slim 125	400	150	392	325	278	123	348	300	84	72	300
KVK Slim 160	400	185	392	325	278	158	348	300	99	90	370
KVK Slim100 EC	400	150	392	325	278	98	348	300	69	76	300
KVK Slim120 EC	400	150	392	325	278	123	348	300	84	72	300
KVK Slim160 EC	400	185	392	325	278	158	348	300	99	90	370

Wiring

230V 1~

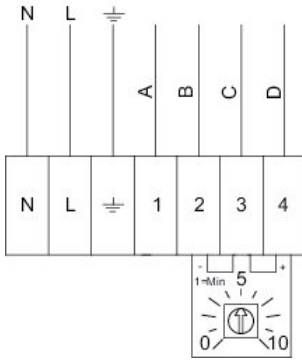

Terminal	Cable	Description
1	Black 1	Tacho output, Isink max 10mA
2	Black 2	GND
3	Black 3	Control input 0-10 VDC/PWM
4	Black 4	Output 10 VDC max 1.1 mA

Ecodesign

Product	
Trade name	Systemair
Product name	KVK Slim 125 EC
Basic unit	
ErP compliance	2016
SEC Average	-12.4 kWh/(m ² .a)
SEC Cold	-28.8 kWh/(m ² .a)
SEC Warm	-3 kWh/(m ² .a)
SEC Class	E
Unit category	RVU
Unit type	UVU
Drive	Integrated VSD
Heat recovery type	None
Temperature ratio (UVU)	Not applicable
qv max	425 m ³ /h
P max	115 W
Sound power level LWA	46 dB(A)
qv ref	0.083 m ³ /s
Ps ref	50 Pa
SPI	0.151 W/(m ³ /h)
CTRL	1
MISC	1.1
x-value	2
External Leakage	0.4 %
AEC average	190 kWh
AHS Cold	190 kWh
AEC warm	190 kWh
AHS Average	1,715 kWh/a
AHS Cold	3,355 kWh/a
AHS Warm	776 kWh/a

Units with local demand control		
ErP compliance		2018
SEC Average	-26.3	kWh/(m ² .a)
SEC Cold	-53.4	kWh/(m ² .a)
SEC Warm	-10.8	kWh/(m ² .a)
SEC Class		B
Unit category		RVU
Unit type		UVU
Drive		Integrated VSD
Heat recovery type		None
Temperature ratio (UVU)		Not applicable
qv max	425	m ³ /h
P max	115	W
Sound power level LWA	46	dB(A)
qv ref	0.0826	m ³ /s
Ps ref	50	Pa
SPI	0.151	W/(m ³ /h)
CTRL	0.65	
MISC	1.1	
x-value	2	
External Leakage	0.4	%
AEC average	80	kWh
AEC cold	80	kWh
AEC warm	80	kWh
AHS Average	2,830	kWh/a
AHS Cold	5,536	kWh/a
AHS Warm	1,280	kWh/a

Energy class label

Energy class, Basic unit

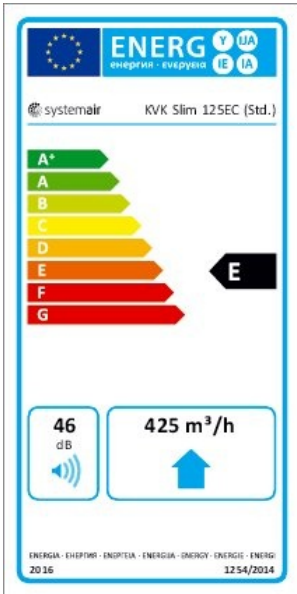

Energy class, Local demand

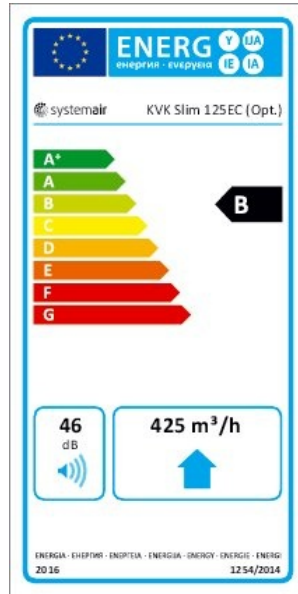

Accessories

- CXE/AVC Modbus (37256)
- EC-Basic-CO2 and temperature (24808)
- EC-Basic-T temperature (24805)
- EC-Selector (9908)
- EC-Vent Room Unit (3018)
- MTP 20, on/off, 3-step (310220)
- REV-3POL/03-7,5kW R/Y (33978)
- SG 125 Protection guard (5607)
- CO2RT-R-D Transmitter (6993)
- IGK-125 Wall Grid (1631)
- RT 0-30 Room Thermostat (5151)
- CB 125-0,6 230V/1 Duct heater (5289)
- CB 125-1,8 230V/1 Duct heater (5377)
- CBMF 125-1,2 230V/1 Duct heater (12242)
- FFR 125 Filter cassette (1768)
- FK 125 Fast clamp (1608)
- LDC 125-300 Silencer (53722)
- LDC 125-900 Silencer (5191)
- VBC 125-2 Water heating batt (5457)
- BMS Trickle & Boost Switch (120363)
- DMD-C Pressure controller (15793)
- EC-Basic-H humidity (24807)
- EC-Basic-U universal 0-10V (24806)
- EC-Vent control board (3115)
- MTP 10, 10K, Speed control (32731)
- MTV-1/010 Controller 0..10V+ (30650)
- S-5EC/FRQ (76738)
- VKK-125 Back draft damper (1624)
- HR1 Room Humidistat (215150)
- Presence detector/IR24-P (6995)
- VBC 125-3 Water heating batt (9839)
- CB 125-1,2 230V/1 Duct heater (5290)
- CBM 125-1,2 230V/1 Duct heater (5480)
- CWK 125-3-2,5 Duct cooler,circ (30021)
- FGR 125 Filter cassette (1804)
- LDC 125-1200 Silencer (5997)
- LDC 125-600 Silencer (5190)
- RSK-125 Back draft damper (5598)
- VBF 125 Water heating battery (1730)